

Soils Map

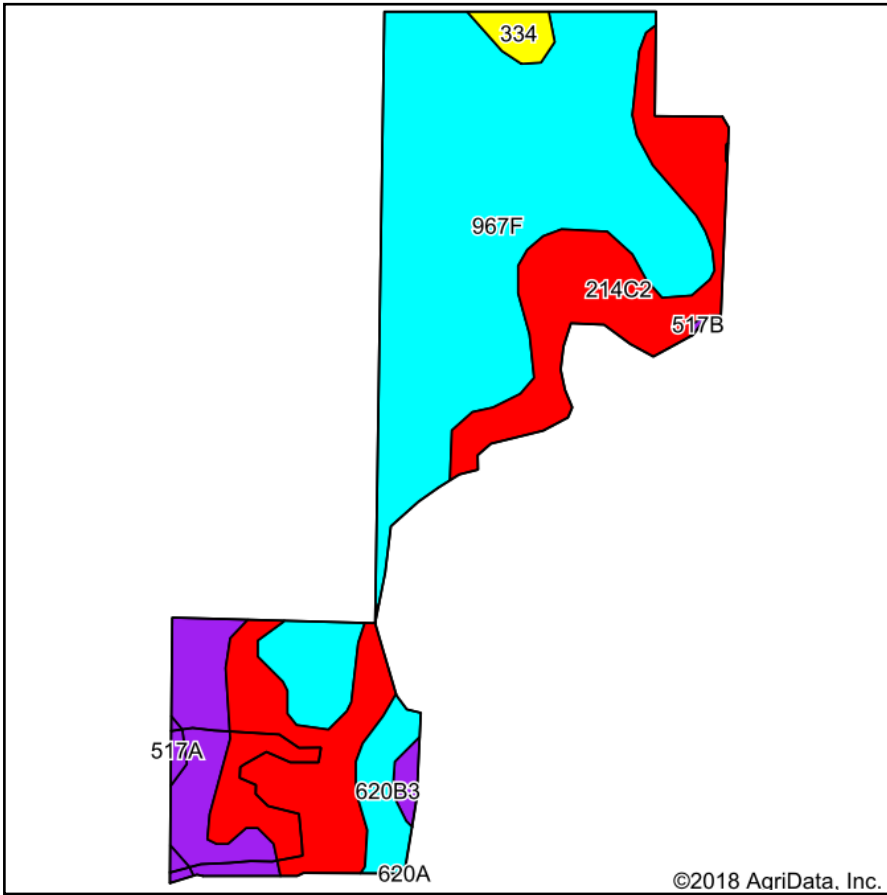

Soils data provided by USDA and NRCS.

©2018 AgriData, Inc.

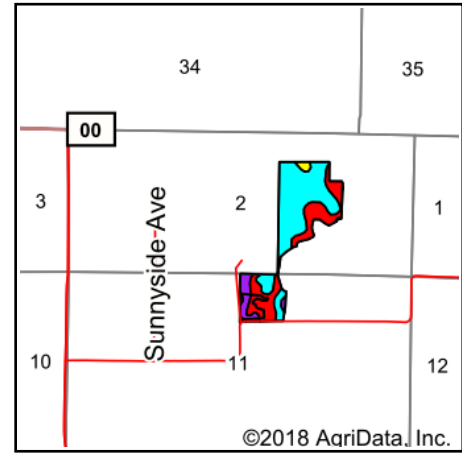

©2018 AgriData, Inc.

State: **Illinois**
 County: **Bond**
 Location: **2-6N-5W**
 Township: **Shoal Creek**
 Acres: **35.79**
 Date: **1/29/2018**



TARRANT & HARMAN
 REAL ESTATE AND AUCTION CO
residential - commercial - agricultural

Maps Provided By:



© Agridata, Inc. 2018

www.AgridataInc.com



Area Symbol: IL005, Soil Area Version: 13

Code	Soil Description	Acres	Percent of field	Il. State Productivity Index Legend	Subsoil rooting a	Corn Bu/A	Soybeans Bu/A	Wheat Bu/A	Oats Bu/A b	Sorghum c Bu/A	Alfalfa d hay, T/A	Grass-legume e hay, T/A	Crop productivity index for optimum management
**967F	Hickory-Gosport complex, 15 to 30 percent slopes	19.55	54.6%		UNF	**90	**31	**37	**43	0	0.00	**2.93	**69
**214C2	Hosmer silt loam, 5 to 10 percent slopes, eroded	11.06	30.9%		UNF	**126	**41	**52	0	**99	**3.28	0.00	**95
**214B	Hosmer silt loam, 2 to 5 percent slopes	2.77	7.7%		UNF	**139	**46	**57	0	**109	**3.60	0.00	**104
**620B3	Darmstadt silt loam, 2 to 5 percent slopes, eroded	1.31	3.7%		UNF	**110	**40	**41	0	**92	0.00	**3.39	**86
334	Birds silt loam, frequently flooded, long duration	0.58	1.6%		FAV	157	51	61	75	0	4.89	0.00	117
916A	Oconee-Darmstadt silt loams, 0 to 3 percent slopes	0.29	0.8%		UNF	136	46	51	0	107	0.00	4.29	104
517A	Marine silt loam, 0 to 2 percent slopes	0.23	0.6%		FAV	144	45	56	0	113	3.39	0.00	104
Weighted Average						107.5	36.1	44	24.7	44	1.39	1.76	81.7

Table: Optimum Crop Productivity Ratings for Illinois Soil by K.R. Olson and J.M. Lang, Office of Research, ACES, University of Illinois at Champaign-Urbana. Version: 1/2/2012 Amended Table S2 B811

Crop yields and productivity indices for optimum management (B811) are maintained at the following NRES web site: <http://soilproductivity.nres.illinois.edu/>

** Indexes adjusted for slope and erosion according to Bulletin 811 Table S3

a UNF = unfavorable; FAV = favorable

b Soils in the southern region were not rated for oats and are shown with a zero "0".

c Soils in the northern region or in both regions were not rated for grain sorghum and are shown with a zero "0".

d Soils in the poorly drained group were not rated for alfalfa and are shown with a zero "0".

e Soils in the well drained group were not rated for grass-legume and are shown with a zero "0".

Soils data provided by USDA and NRCS. Soils data provided by University of Illinois at Champaign-Urbana.

*c: Using Capabilities Class Dominant Condition Aggregation Method